

# MFX 24-CO

**Stainless steel [A2]**  
Polished

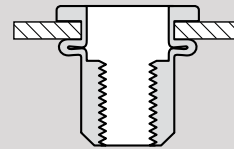
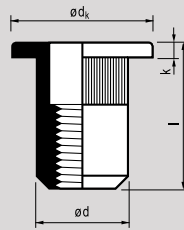

## MASTERGRIP | open end | cylindrical head

$\emptyset d$		$l$ [+0,5/-0]		Item nr.	$\emptyset dk$ [+0/-0,5]	$k$ $\leq$	$\emptyset d$ [+0/-0,2]			
[mm]		[mm]	[mm]		[mm]	[mm]	[mm]	[Nm]	[N]	[N]
<b>M4</b>	!	11,0	0,5-3,0	<b>24M04CO1*</b>	9,0	1,1	5,9	7,0	7.800	2.600
	!	14,0	3,0-4,5	<b>CO2</b>						
$\emptyset 6,0$										
<b>M5</b>	!	13,0	0,5-3,0	<b>24M05CO1*</b>	10,0	1,1	6,9	12,0	11.760	3.920
	!	16,0	3,0-5,5	<b>CO2</b>						
$\emptyset 7,0$	*	19,0	5,5-8,0	<b>CO3</b>						
<b>M6</b>	!	16,0	0,5-3,0	<b>24M06CO1*</b>	12,0	1,6	8,9	22,2	20.580	5.630
	!	18,5	3,0-5,5	<b>CO2</b>						
$\emptyset 9,0$										
<b>M8</b>	!	17,5	0,5-3,0	<b>24M08CO1*</b>	15,0	1,6	10,9	30,5	26.460	7.800
	!	20,0	3,0-5,5	<b>CO2</b>						
$\emptyset 11,0$										
<b>M10</b>	!	19,0	0,5-3,0	<b>24M10CO1</b>	16,0	2,1	12,9	39,0	35.280	8.800
	!	24,0	3,0-6,0	<b>CO2</b>						
$\emptyset 13,0$										

\* these rivets of range 24-CO are also available in blister pack.



=	identical to old program
!	improved technical data
*	addition